

# THE BEST SOLUTION



## SUPERIOR WALLS Xi FOUNDATION SYSTEM

### DRY

*Your permanent barrier against sidewall water penetration*

- 1 Clean Crushed Stone Footing
- 2 Auxiliary Drain Pipe
- Superior Sealant\* Applied in All Joints for Permanent Moisture Barrier

### WARM

*Warmer in winter; cooler in summer... reduces your home's energy loss*

- 3 2-1/2" Dow® Extruded Polystyrene Insulation
- 4 1" Foam Insulated Concrete Studs
- 5 1" Foam Insulation on Bond Beam

### SMART

*Ready to finish...with pre-engineered access built-in*

- 6 Access Holes for Ease in Wiring and Plumbing
- 7 Galvanized Steel Stud Facing Ready for Drywall Finishing
- CAD Custom-Designed to Virtually Any Home Style
- Laser-Leveled to be Plumb, Level, Square
- Installs on Your Site in Just Hours for Time and Money Savings
- America's Strongest Foundation Guarantee\*

### SUPERIOR

*Steel reinforced...and backed by the industry's strongest guarantee\**

- 5,000+ PSI Concrete for Superior Strength
- 8 Horizontal Steel Rebar Inside Top and Bottom Beams
- 9 Steel Reinforced Top Bond Beam
- 10 Vertical Steel Rebar (Inside Each Stud)
- 11 1-3/4" Concrete Face Shell
- 12 10-1/4" Overall Wall Thickness
- 13 Steel Reinforced Concrete Studs
- 14 Steel Reinforced Footer Beam
- 15 Concrete Floor

*Special Note: Items #1,2,&15 as well as the joist/flooring system are provided on site per Superior Walls specifications by builder and contractors as an integral part of the Superior Walls foundation system.*

*\*See the limited warranty. Contact your local Superior Walls representative for details.*



## Superior Walls®

THE FOUNDATION  
OF EVERY SUPERIOR NEW HOME™

[www.superiorwalls.com](http://www.superiorwalls.com)

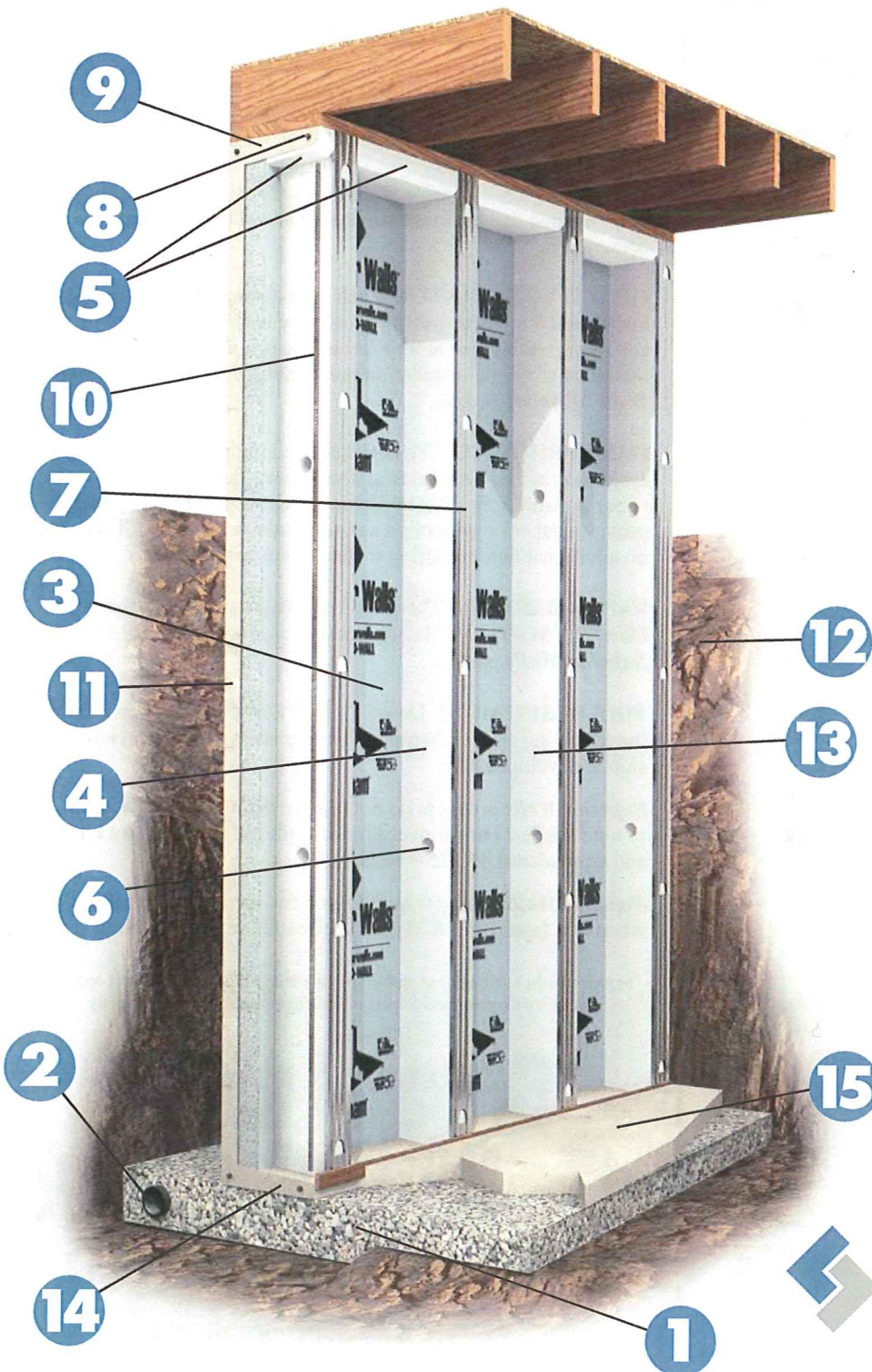



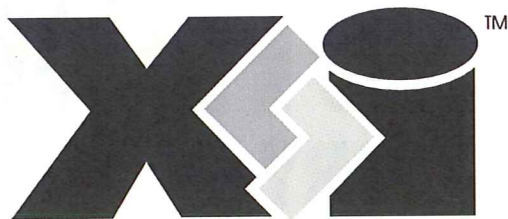

## EXTRA STRENGTH. EXTRA INSULATION.

- Provided with 2-1/2" of insulation = R-12.5
- 5000+ PSI concrete reinforced with rebar and polypropylene fibers
- Precast access holes for wiring and plumbing
- Meets Energy Conservation Code requirements for basements (IECC, IRC Chapter 11)
- Thermally isolated/insulated from exterior
- Insulated corners, studs and bond beam
- Monolithically poured = greater strength
- Galvanized steel stud facing
- May be insulated up to R-50+
- No additional dampproofing required
- Precast openings for windows and doors
- Reduces building time
- Ready in virtually any weather

**Superior  
In Every Way.  
Guaranteed.\***



\*See the limited warranty.  
Contact your local Superior Walls  
representative for details

## General Specifications

*Superior Walls* products are insulated precast concrete wall systems that are custom manufactured to each building's specification. The Xi product forms a concrete cavity wall panel with concrete studs at 24 inches on center attached at the top and bottom with bond beams and the entire assembly is faced with an integral concrete face shell. The wall is reinforced with rebar and polypropylene fibers providing additional structural strength. In addition, the concrete studs are cast with holes for wiring and factory galvanized steel on each stud for interior finishing. For more information see [www.superiorwalls.com](http://www.superiorwalls.com).

*Superior Walls* panels are available in a variety of standard heights and custom lengths to suit your project. The maximum axial load (uniform house weight) for this product is 5500 pounds per linear foot. Special point loads up to 50,000 pounds can be accommodated.

**WARRANTY\*** *Superior Walls* Xi product is warranted for 15 years against defects in workmanship and side wall water penetration.

**QUALITY ASSURANCE** Each manufacturing plant is regularly inspected by an independent third-party inspection agency to ensure compliance with the Quality Assurance program. In addition, manufacturing and installation personnel are certified by *Superior Walls of America, Ltd.*

**DAMPPROOFING** The concrete used in the *Superior Walls* wall systems provides protection against freeze/thaw cycles and water vapor transmission. The urethane sealant used between panels provides superior protection against water penetration. Therefore, no additional dampproofing materials are required.

**VAPOR BARRIER** The closed cell polystyrene material in the Dow STYROFOAM™ Insulation provides a vapor barrier for *Superior Walls* panels.

**FIRE RESISTANCE** Dow STYROFOAM™ Insulation exhibits the following surface burning characteristics: flame spread 5 and smoke developed 165.

*Superior Walls* products do not require the attachment of a 15-minute thermal barrier over the foam plastic as proven by UL 1715 and equivalent UBC 26-3 tests.

*Superior Walls* products qualify as a two-hour fire separation wall when two layers of 5/8" Type 'X' drywall are applied to the studs.

*Superior Walls of America* manufacturers are independently owned and operated. Check with your local *Superior Walls* representative for availability.

**Great Lakes  
Superior Walls®**  
**1-800-486-2932**

[www.superiorwalls.com](http://www.superiorwalls.com)